

## Woodcraft Kitchen and Bath Cabinet Specifications, Options & Pricing Guide.

The quality construction of Woodcraft Kitchen and Bath kitchen cabinets make them a wise choice for homeowners who value the quality and durability of American manufactured, semi-custom cabinets and for dealers and builders who want professional service and value.



# WOODCRAFT KITCHEN & BATH

*This guide is designed to be a quick reference for finding the cabinets you want to order by defining the detailed specifications and dimensions of your wall, base and vanity cabinets as well as accessories, finishing specifications and suggested retail pricing.*

If you need further clarification, please contact the Woodcraft customer satisfaction team.

Phone 814.548.7607

Fax 888.215.1348

Email: [info@Woodcraftkitchenandbath.com](mailto:info@Woodcraftkitchenandbath.com)

Visit: [www.WoodcraftKitchenandBath.com](http://www.WoodcraftKitchenandBath.com)

Woodcraft Kitchen and Bath  
is a proud member of



All images and content of this book are Copyright © 2014 by Woodcraft Management Services, Inc. You should not disseminate, distribute or copy any images or written content of this book.



Manufactured in the U.S.A.  
© 2014 Woodcraft Kitchen and Bath  
All rights reserved.  
10212014

# 12" - 15" High Wall Cabinets

## Wood Species

2



**Maple:** a light colored hardwood, Maple has a close, fine, uniform texture that is generally straight-grained. This is a very durable hardwood and will take any color stain or paint well.



**Oak:** has a reddish cast and is a very hard wood with a mostly straight open grain. This is an extremely durable, great wear-resistance hardwood that stains well to a beautiful finish.



**Cherry:** has beautiful reddish brown to deep red color with lighter streaks of sapwood. Cherry has a fine uniform, straight grain, satiny smooth texture, the beauty of this hardwood and accompanying even grain has been a favorite choice of customers for centuries.

Door Styles

## Creating a Kitchen

✧ **1. Select your cabinet grade.** Choose from Premium, Deluxe or Select grades for more style and quality choices.

Select icon



Deluxe icon



Premium icon



✧ **2. Choose your style.** Select the door and drawer style you prefer for the look you want. Options include: Square, Arch, and Cathedral in Flat Panel, Raised Panel and Beadboard styles.

✧ **3. Layout your kitchen.** Make your space beautiful and functional with base, wall, pantry, corner and utility cabinets. Plan the best arrangement for your lifestyle.

✧ **4. Select an island.** Solid wood kitchen islands come in six designer styles for a welcome addition to your kitchen for work space, storage and seating.

✧ **5. Add glass.** Enhance your cabinets with glass to show off your cherished objects.

✧ **6. Add space saving storage and accessories.** Convenient accessories make your working kitchen even better.

✧ **7. Select a wood species.** See the wood species descriptions below and choose from Maple, Oak or Cherry.

✧ **8. Select the finish.** Warm stains, paints and specialty finishes add to the personality of your kitchen. Choose from our selection of 26 finishes including stain, paint & glazes or get your cabinets unfinished to customize yourself.

## Cabinet Grades



**Woodcraft Select:**  
Our highest quality all wood cabinets. Solid wood face frames and doors.



**Woodcraft Deluxe:**  
Quality furniture board cabinets with plywood sides. Solid wood face frames and doors.



**Woodcraft Premium:**  
Quality furniture board case cabinets. Solid wood face frames and doors.

The ultimate source for quality, American made, semi-custom cabinets and furniture.

Pride and experience go into every Woodcraft cabinet.

Since 1984, Woodcraft Kitchen and Bath has produced an impressive selection of semi-custom Kitchen & Bath Cabinetry and a full line of “furniture for every room in the home and office.”

Every cabinet has been designed and engineered to support Woodcraft Kitchen and Bath’s quality standards. You can be sure that every Kitchen and Bath cabinet will bring years of pride in ownership.

Woodcraft cabinets are available in Woodcraft Premium, Woodcraft Deluxe, and Woodcraft Select grades, an impressive 26 finishes and 13 door & drawer styles. Numerous accessories and the ability to modify cabinet sizes create unlimited possibilities for your kitchen and bathrooms.

All Woodcraft Kitchen and Bath cabinets are covered by our Lifetime Limited Warranty.



Woodcraft Kitchen and Bath  
is a proud member of



Manufactured in the U.S.A.

## Environmentally Responsible

- Our real wood construction reveals the classic beauty of responsibly harvested premium grade maple, oak and cherry. Woodcraft Kitchen and Bath is committed to using suppliers that share our values. Our vendors are certified by the Forest Stewardship Council (FSC) for their controlled harvesting of wood products from managed forests, adhering to strict environmental standards in accordance with the principles and criteria of the FSC. The wood waste produced is minimal as excess wood chips and sawdust are utilized by local farms as animal bedding.
- State of the art finishing system utilizes a high solid conversion varnish that emits very low voc's. Because of the finishes high build properties, a high quality finish is produced with fewer steps in the finishing process.
- Woodcraft Kitchen and Bath's goal is to be a resource and partner with you in making our environment a safe and healthy place to live. The longevity and durability of our furniture guarantees it will last for generations to come.



Woodcraft Kitchen and Bath  
[www.Woodcraftkitchenandbath.com](http://www.Woodcraftkitchenandbath.com)

© 2014 Woodcraft Kitchen and Bath  
All rights reserved.

---

# Woodcraft Kitchen and Bath

## Contact Information

Phone: 814.548.7607

Fax: 888.215.1348

Email: [info@woodcraftkitchenandbath.com](mailto:info@woodcraftkitchenandbath.com)

Website: [www.woodcraftkitchenandbath.com](http://www.woodcraftkitchenandbath.com)

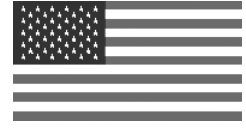

Manufactured in the U.S.A.

## Limited Lifetime Warranty

**Woodcraft Kitchen and Bath warrants to the original consumer purchaser that our cabinetry will be free from defects in material and workmanship under normal use for the lifetime of the original purchaser.** This warranty only applies to Woodcraft Kitchen and Bath cabinets or related products purchased through a current authorized Woodcraft Kitchen and Bath dealer. This warranty is in lieu of all other implied or expressed warranties.

Woodcraft Kitchen and Bath may elect to repair or replace any defective Woodcraft Kitchen and Bath product covered by our warranty. Our warranty does not cover defects caused by misuse, abuse, negligence, alterations, environmental conditions, exposure to extremes in temperature or humidity, improper installation, storage and handling, shipping damage caused by the freight company; nor any labor expenses or incidental or consequential damages. Our warranty does not cover natural variations in wood including distinctive grain patterns, variations in color and variations in texture. This warranty does not apply to unfinished products.

Woodcraft Kitchen and Bath may change design, specifications and materials as conditions require and improvements are developed, but we have no obligation to incorporate such changes into products we previously manufactured. Woodcraft Kitchen and Bath reserves the right to make material and specification changes to Woodcraft Kitchen and Bath products without prior notification. Material and specification changes are not valid reasons for a warranty claim.

To file a warranty claim, first contact your current authorized Woodcraft kitchen and bath cabinet dealer who will arrange for inspection of the cabinet. An original dated sales receipt as proof of purchase is required to obtain benefits from this warranty. Only written warranty claims will be accepted.

Woodcraft Kitchen and Bath  
is a proud member of



Woodcraft Kitchen and Bath  
[www.woodcraftkitchenandbath.com/kitchen](http://www.woodcraftkitchenandbath.com/kitchen)



© 2014 Woodcraft Kitchen and Bath  
All rights reserved.

All images and content of this book are  
Copyright © 2014 by Woodcraft Management Services, Inc.  
You should not disseminate, distribute or copy any images  
or written content of this book. Please notify Woodcraft  
Management Services, Inc. for permission if you desire to use  
images or content for your business promotions.

# CONTENTS

Creating a Kitchen .....	2
Real Wood Cabinets .....	3
Woodcraft Kitchen and Bath .....	4
Kitchen Layout Guides .....	6
Take Measurements .....	7
Door Hinges & Door Overlays .....	8
Drawer Options .....	9

## Door Styles

Winthrop Flat Panel .....	10
Claremont Flat Panel .....	11
Lycoming Flat Panel .....	12
Rockport Flat Panel .....	13
Cameron Flat Panel .....	14
Middleton Flat Panel .....	15
Berkshire Flat Panel .....	16
Newton Flat Panel .....	16B
Stratton Flat Panel .....	17
Saybrook Flat Panel .....	17B
Windsor Reversed Raised Panel .....	18
Lynfield Raised Panel .....	19
Bellingham Raised Panel .....	20
Dartmouth Bead Board .....	21
Albany Solid Slab .....	22
Door Style Pricing Summary .....	23

## Cabinet Options Guide

Cabinet Height Dimensions .....	24
Cabinet Height Dimensions .....	25
Price Accessories Guide .....	26
Price Options Calculator .....	27
Door Options Price Guide .....	28
Box Modifications .....	28
Modification Price Guide .....	29
Helpful Ordering Information .....	30

## Wall Cabinets

12" - 15" High Wall Cabinets .....	32
12" - 15" High Wall Cabinets .....	33
18" High Wall Cabinets .....	34
18" High Butt Door Wall Cabinets .....	35
24" Deep Refrigerator Wall Cabinets .....	35
24" High Wall Cabinets .....	36
24" Butt Door Wall Cabinets .....	37
24" Deep Refrigerator Wall Cabinets .....	37
30" Wall Cabinets .....	38
30" High Wall Cabinets .....	39
30" High Wall Cabinets .....	40
30" High Wall Cabinets .....	41
30" Wall Cabinets with Drawer .....	42
30" Island Wall Cabinets .....	43
30" High Wall Blind Corner Cabinets .....	44
30" High Wall Blind Corner Cabinets .....	45
30" Butt Door Wall Cabinets .....	46
30" Easy Reach Corner Wall Cabinets .....	47
30" High Wall Corner Cabinets .....	48
30" High Wall Lazy Susan Cabinets .....	49
36" High Wall Cabinets .....	50
36" High Wall Cabinets with Drawer .....	50
36" High Wall Cabinets .....	51
36" High Wall Cabinets .....	52
36" High Combo Door Wall Cabinets .....	52
36" High Wall Cabinets .....	53
36" High Wall Cabinets .....	54
36" Island Wall Cabinets .....	55
36" Blind Corner Wall Cabinets .....	56
36" Blind Wall Cabinets .....	57
36" High Wall Lazy Susan Cabinets .....	58
36" High Corner Cabinet .....	58
36" Butt Door Wall Cabinets .....	59
36" Easy Reach Corner Wall Cabinets .....	59

39" High Wall Cabinets .....	60
39" High Wall Cabinets with Drawer .....	60
39" High Wall Cabinets .....	61
39" High Wall Cabinets .....	62
39" High Combo Door Wall Cabinets .....	62
39" High Wall Cabinets .....	63
39" High Wall Cabinets .....	64
39" High Island Wall Cabinets .....	65
39" Blind Corner Wall Cabinets .....	66
39" Butt Door Wall Cabinets .....	67
39" High Wall Lazy Susan Cabinets .....	68
39" High Corner Cabinet .....	68
39" Easy Reach Corner Wall Cabinets .....	69
42" High Wall Cabinets .....	70
42" High Wall Cabinets .....	71
42" High Wall Cabinets .....	72
42" Island Wall Cabinets .....	73
42" High Combo Wall Cabinets .....	74
42" High Wall Cabinets with Drawer .....	75
42" Blind Corner Wall Cabinets .....	76
42" Butt Door Wall Cabinets .....	77
42" Lazy Susan Corner Wall Cabinets .....	78
42" High Corner Cabinet .....	78
42" Easy Reach Corner Wall Cabinets .....	79
Angled Wall Cabinets .....	80
Angled End Wall Cabinets .....	80
Angled Wall with Garage Cabinets .....	81
Microwave Wall Cabinets .....	82
Microwave Wall Cabinets .....	83
Pantry Pullout Wall Cabinets .....	84
Spice Pullout Wall Cabinets .....	84
Wine Cubby Cabinets .....	85

## Base Cabinets

Base Cabinets .....	86
Base Island Cabinets .....	91
Butt Door Base Cabinets .....	92
Base Corner Cabinets .....	93
Lazy Susan Base Cabinets .....	94
Corner Base Cabinets .....	95
Microwave Base Cabinets .....	96
Waste & Recycling Base Cabinets .....	97
Drawer Base Cabinets .....	98
Pantry & Spice Pullout Base Cabinets .....	102
Wine Storage Base Cabinets .....	103
Blind Corner Base Cabinets .....	104
Blind Corner Base Cabinets .....	105
Angled Base Cabinets .....	106
Sink Fronts .....	108
Corner Sink Fronts .....	110
Sink & Range Base Cabinets .....	111
Recessed Diagonal Sink Base .....	112
Farm Sink Base .....	112
Corner Sink Cabinets .....	113
Oven Cabinets .....	114

## Utility & Pantry Cabinets

Pantries with Pullouts .....	116
Utility Cabinets with Shelves .....	118
Utility Cabinets .....	122
Utility Cabinets with Drawers .....	126

## Accessory Cabinets

Tapered Wooden Hood .....	128
Details make the kitchen function .....	129
End Shelves .....	130
Appliance Garages & Tilt-Out Drawers .....	131
Horizontal & Vertical Wine Racks .....	132
Stemware Holders & Plate Racks .....	133
Apothecary Drawers & Desk Drawers .....	134
Organizer Accessories .....	135

## Kitchen Islands

Shaker Kitchen Island .....	136
Provincial Kitchen Island .....	137
Cottage Kitchen Islands .....	138
Vintage Kitchen Island .....	139
Fluted Kitchen Island .....	140
Country Kitchen Island .....	141

## Bathroom Cabinets

Bathroom Vanity Cabinets .....	142
Bathroom Vanity Cabinets .....	143
Vanity Cabinets .....	144
Narrow Vanity Cabinets .....	145
Combo Vanities .....	146
Drawer & Hamper Vanity Cabinets .....	152
Drawer & Hamper Vanity Cabinets .....	153
Linen Cabinets .....	154

## Medicine Cabinets

Medicine Cabinets .....	158
Mirrors .....	160

## Designer Vanities

Hampshire Designer Vanities .....	162
Cottage Designer Vanities .....	164
Shaker Designer Vanities .....	166
Vintage Designer Vanities .....	168
Fluted Designer Vanities .....	170
Provincial Designer Vanities .....	172

## Strips & End Panels

Trim .....	174
Base Moulding .....	175
Crown Moulding .....	176
Cove Moulding .....	177
Toe Kick .....	177
Classic & Mission Valances .....	178
Scalloped, Straight & Arched Valances .....	179
Filler Strips .....	180
Inside Corner Filler Strips .....	181
Fluted Filler Strips .....	182
Fluted Angle Filler Strips .....	183
End Skins .....	184
Matching End Panels .....	185
End Panels .....	186
Vanity End Panels & Skins .....	187
Vanity End Panels .....	188
Appliance End Panels & Corbels .....	179
Plywood Sheets & Toe-kick .....	190

## Factory Finishing

Factory Finishing .....	192
-------------------------	-----

## Product Orders

Conditions of Sale .....	191
Order and Quote Forms .....	Back of Book

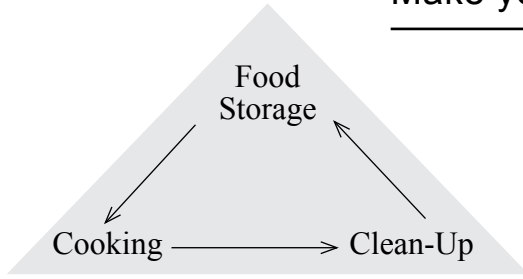

### Food Storage:

- Refrigerator
- Freezer
- Pantry

*It is recommend that your food storage is as close to the kitchen entry as possible for efficient unpacking and less distance to lug heavy groceries.*

### Cooking:

- Range
- Ovens
- Cookware

*Your cooking components should be near each other; by having your cookware close at hand to your range & oven you save time in meal prep.*

### Clean Up:

- Sink
- Dishwasher
- Dish Storage

*Place your dishwasher near your sink and disposal, then dirty dishes can be tackled easily.*

## Some Common Kitchen Layouts

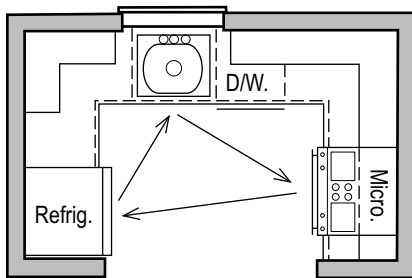

### U-shaped

*If you could use more space consider a U-shape. It is perfect for one or more cooks.*

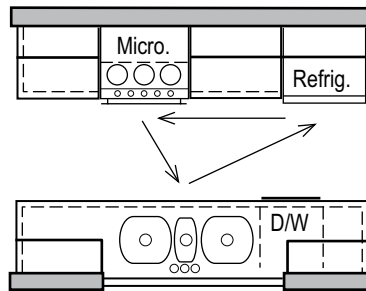

### Galley

*A galley is an efficient workspace for a single cook.*

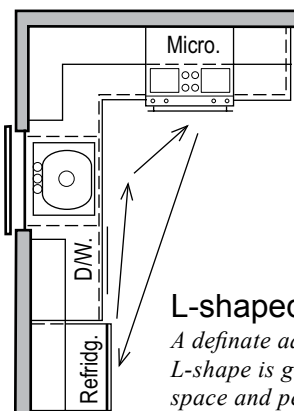

### L-shaped

*A definite advantage of the L-shape is generous counter space and people can come in and out without entering your work area.*

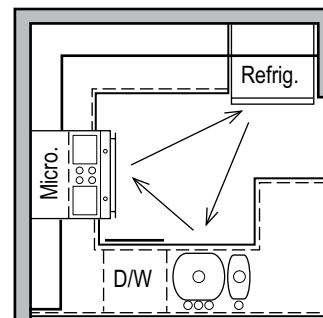

### G-shaped

*A modification of the U-shape, the G adds more cabinets and a potential fourth wall.*

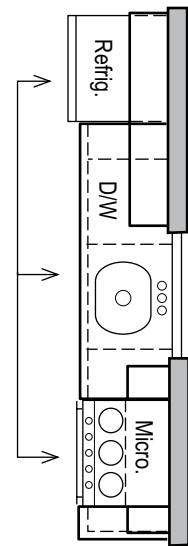

### Single Wall

*A single wall layout is a necessity in smaller homes and apartments where space is limited.*

- Make a sketch of your room; mark all doors, windows, electrical outlets and permanent fixtures.
- Measure in inches not feet.
- Measure openings: doors and windows from the outside trim edge.
- Indicate which way the doors swing. 
- Once you have accurate measurements transfer it to grid paper.

## Walls

1. Measure the full length of the wall from the left corner out.
2. Measure segments: From the left measure to the outer edge of the first opening (*door or window*).
3. Measure across the opening from outside trim edge to outside trim edge.
4. Measure from the outside trim edge of that opening to the next opening or the end of the wall.

## Windows:

1. Measure from floor to window sill.
2. Measure from window sill to top of window.
3. Measure from top of the window to ceiling
4. Measure the width of the window.

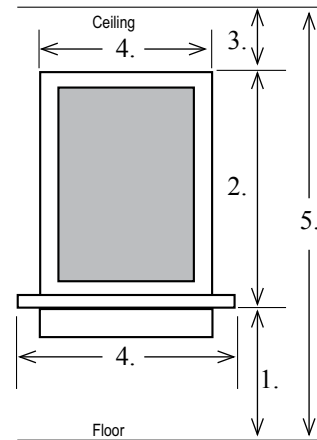

## Details:

1. Make a list of all kitchen appliances
2. Measure the width, height and depth of all relevant appliances.
3. Measure construction details such as bulkheads, crown mouldings etc.

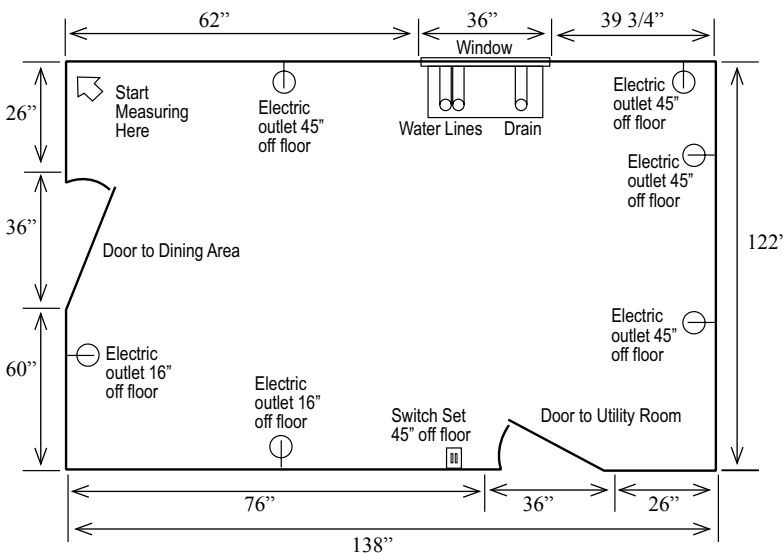
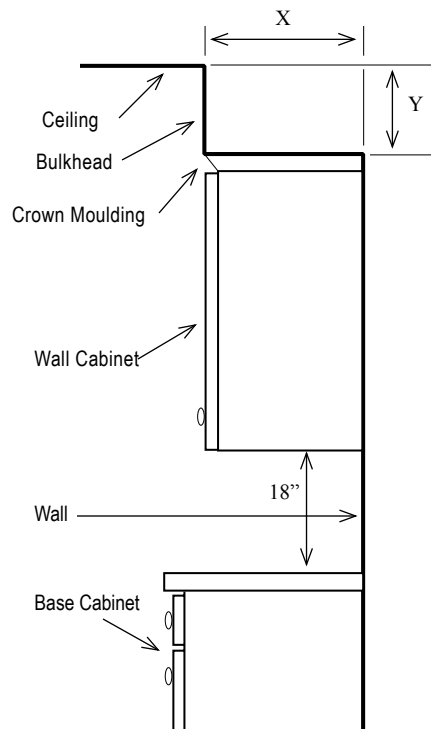

# Door Hinges & Door Overlays

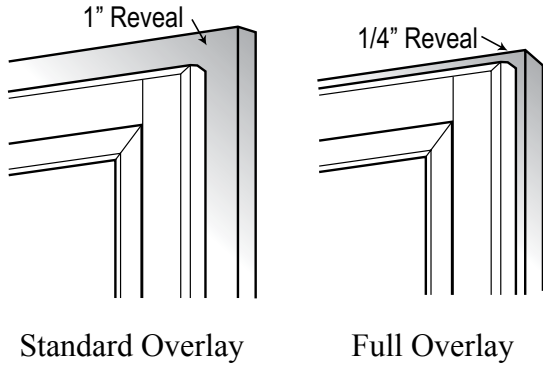

*Note: Cabinet face frame rails and stiles are 1 1/2" wide.*

Cope and stick construction: the joints are machined to interlock with a tongue and groove, glued, clamped and pin nailed during assembly.

Mitered door construction: has a 45 degree angle joint that is glued, clamped and secured with metal fasteners.

The panels are floating panels held in place with rubber spacing balls to absorb any expansion and contraction and keep the panel in place. All of our raised panels and frames are solid wood; flat panels are plywood.



European fully concealed, six-way adjustable hinges

Optional soft close hinge. (SC)

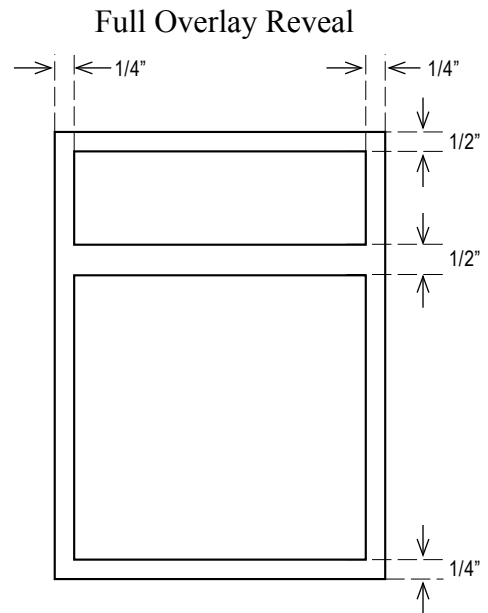
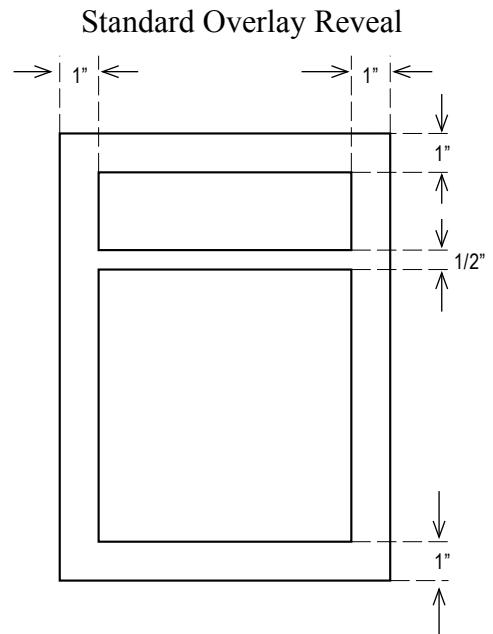

Overlay Options	Hinge Type Options	Drawer Glide Options
Standard 1/2"	European (EU)	Full Extension (F)
Full 1 1/4"	Euro Soft Close (SC)	Undermount Soft Close (SC)



## Drawer Construction

The drawer boxes are English dovetailed on all four corners, 1/4" plywood bottom panel is glued in place and blind nailed to create a strong square drawer box that will endure the test of time.

Drawer face is attached to the front of the box using four panhead screws.



Optional Drawer  
1/2" Thick  
Dovetailed  
Solid Hardwood  
Drawer Box

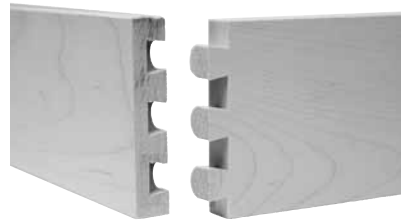

Standard Drawer  
5/8" Thick  
Dovetail  
Solid Maple Wood  
Drawer Box



Glide Option (F)  
Full Extension Ballbearing Glide



Standard Glide (SU)  
Soft-Close Undermount Glide

# Door Style: Winthrop (Pricing Level 1)

# Flat Panel

10

Door Styles Flat Panel

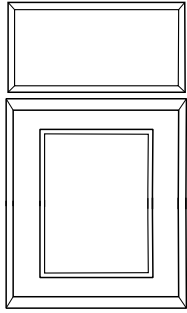

Solid Drawer Front Square Flat Panel Door

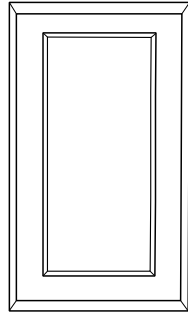

Square Flat Panel Door

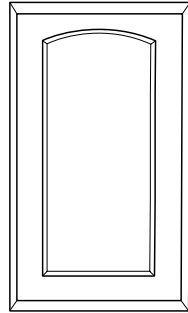

Arch Flat Panel Door

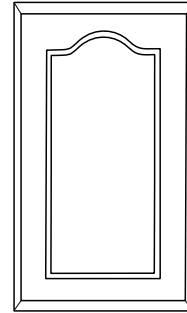

Cathedral Flat Panel Door

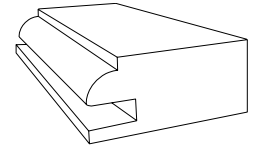

Inside Edge Profile

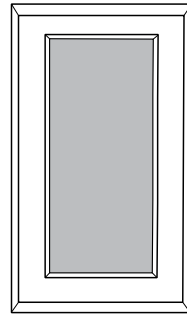

Square Glass Door

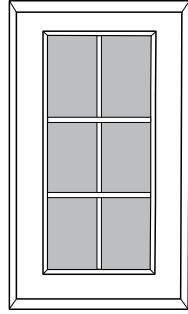

Square Mullion Glass Door

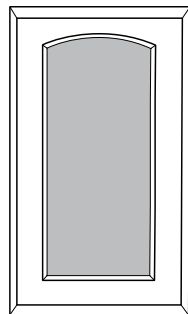

Arch Glass Door

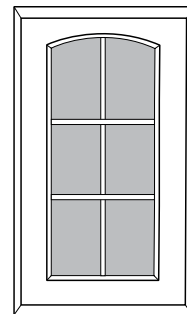

Cathedral Mullion Glass Door

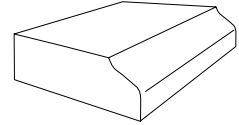

Outside Edge Profile

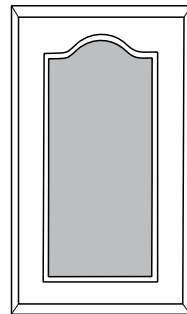

Cathedral Glass Door

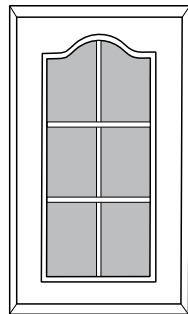

Cathedral Mullion Glass Door

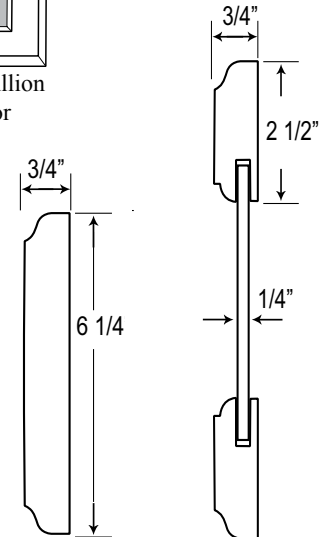

Solid Drawer Front

Flat Panel Door

**Note:** Arch top Rail is 3 1/2" high. Cathedral top Rail is 3 1/2" high.

Name	Door Style	Door Options	Glass Options	Overlay Options	Hinge Options	Drawer Front	Drawer Glide Options
Winthrop	Flat Panel Cope & Stick	Square	Clear Glass	1/2" Standard	European (EU)	Solid	Full Extension (F)
		Arch	Mullions (M)	1 1/4" Full	European Soft Close (SC)		
		Cathedral					

Available in these cabinet grades:



# Flat Panel *(Pricing Level 3)*

# Door Style: Claremont

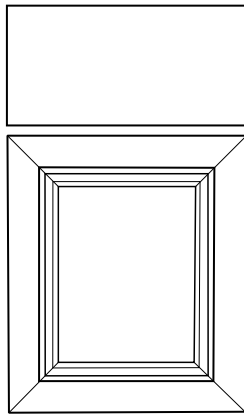

Solid Drawer Front  
Mitered Flat Panel Door

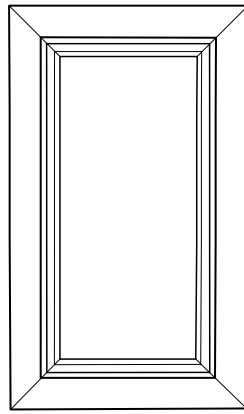

Mitered  
Flat Panel Door

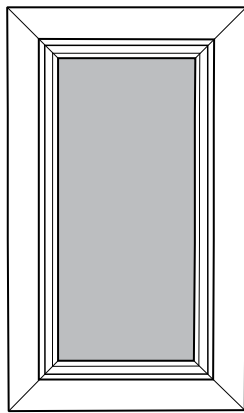

Mitered Glass Door

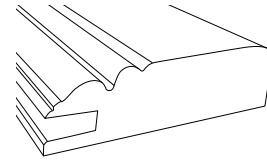

Inside Edge Profile

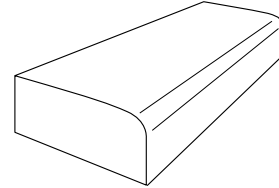

Outside Edge Profile

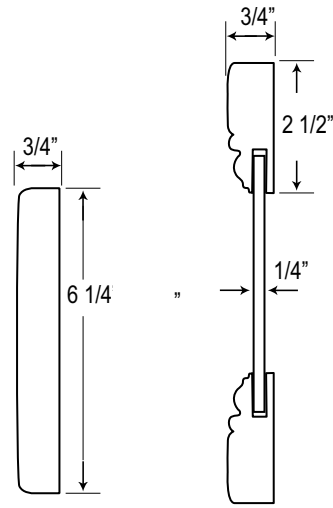

Solid  
Drawer Front

Flat Panel  
Mitered Door

11

Door Styles Flat Panel

Name	Door Style	Door Options	Glass Options	Overlay Options	Hinge Options	Drawer Front	Drawer Glide Options
Claremont	Flat Panel Mitered	Square	Clear Glass	1/2" Standard	European (EU)	Solid	Full Extension (F)
				1 1/4" Full	European Soft Close (SC)		Soft Close Undermount (S)

Available in these cabinet grades:



# Door Style: Lycoming (Pricing Level 4)

# Flat Panel



12

Door Styles Flat Panel

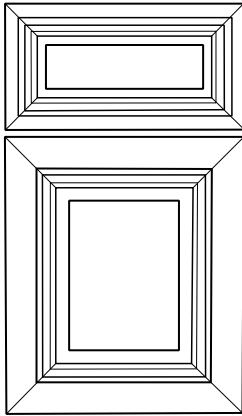

Panel Drawer Front  
Mitered Flat Panel Door

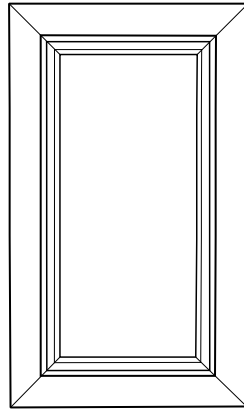

Mitered  
Flat Panel Door

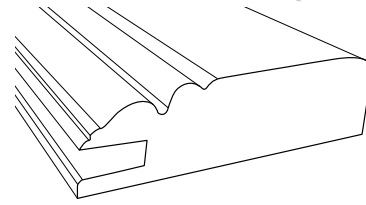

Inside Edge Profile

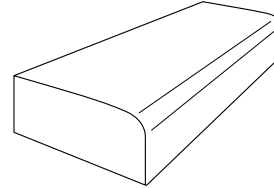

Outside Edge Profile

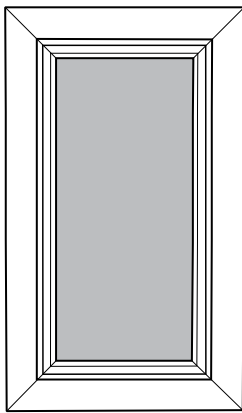

Mitered Glass Door

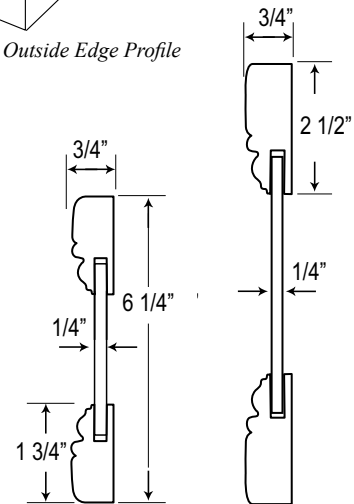

Flat Panel  
Mitered Drawer Front

Flat Panel  
Mitered Door

Name	Door Style	Door Options	Glass Options	Overlay Options	Hinge Options	Drawer Front	Drawer Glide Options
Lycoming	Flat Panel Mitered	Square	Clear Glass	1/2" Standard  1 1/4" Full	European  European Soft Close (SC)	Panel	Full Extension (F)  Undermount Soft Close (S)

Available in these cabinet grades:



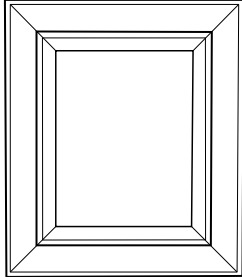
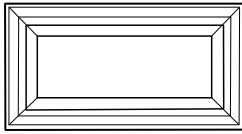

Panel Drawer Front  
Mitered Flat Panel Door

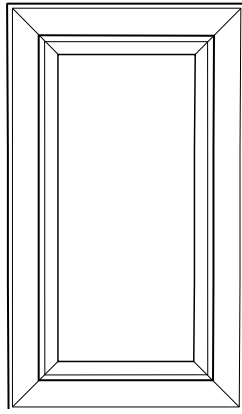

Mitered  
Flat Panel Door

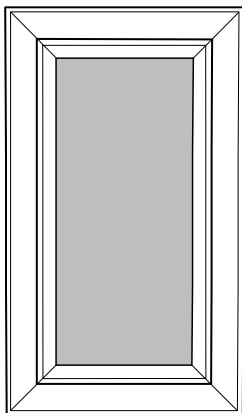

Mitered Glass Door

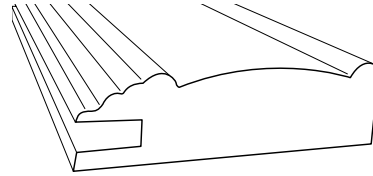

Inside Edge Profile

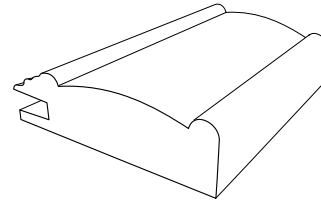

Outside Edge Profile

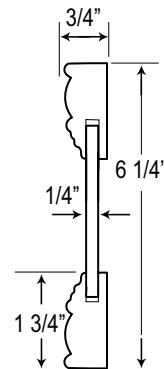

Flat Panel  
Mitered Drawer Front

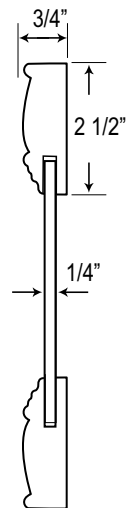

Flat Panel  
Mitered Door

Name	Door Style	Door Options	Glass Options	Overlay Options	Hinge Options	Drawer Front	Drawer Glide Options
Rockport	Flat Panel Mitered	Straight	Clear Glass	1/2" Standard	European	Panel	Full Extension (F)
				1 1/4" Full	European Soft Close (SC)		Undermount Soft Close (S)

Available in these cabinet grades:



# Door Style: Cameron (Pricing Level 1)

# Flat Panel



14

Door Styles Flat Panel

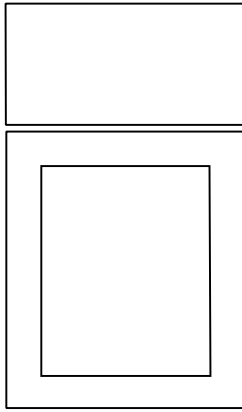

Solid Drawer Front  
Mission Flat Panel Door

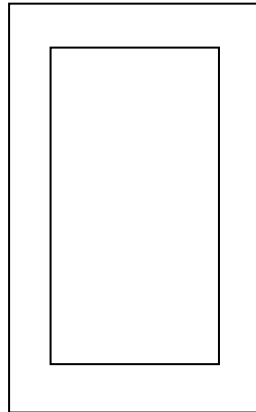

Mission  
Flat Panel Door

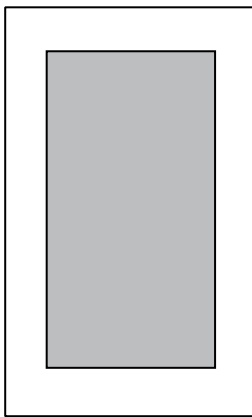

Mission  
Glass Door

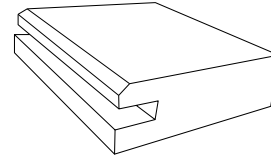

Inside Edge Profile

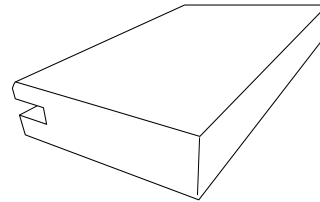

Outside Edge Profile

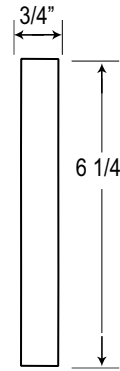

Mission  
Solid Drawer Front

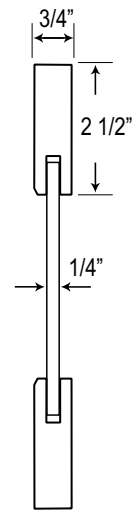

Flat Panel  
Mission Door

Name	Door Style	Door Options	Glass Options	Overlay Options	Hinge Options	Drawer Front	Drawer Glide Options
Cameron	Mission	Square	Clear Glass	1/2" Standard	European	Solid	Full Extension (F)
				1 1/4" Full	European Soft Close (SC)		Undermount Soft Close (S)

Available in these cabinet grades:



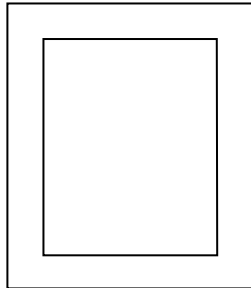
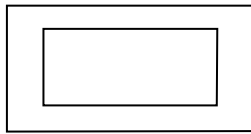

Panel Drawer Front  
Mission Flat Panel Door

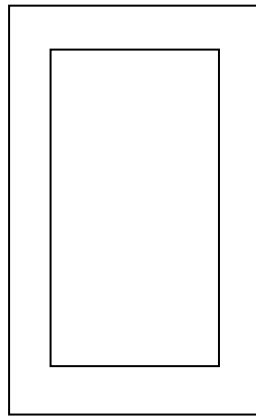

Mission  
Flat Panel Door

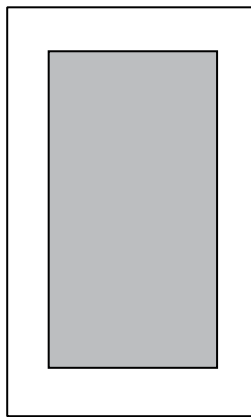

Mission Glass Door

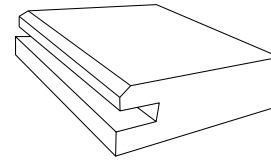

Inside Edge Profile

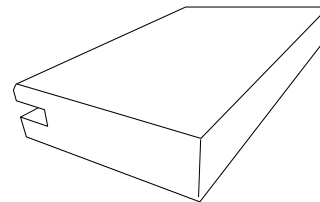

Outside Edge Profile

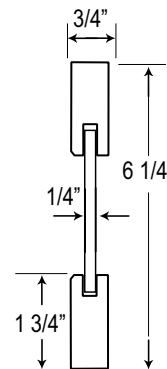

Flat Panel  
Mission Drawer Front

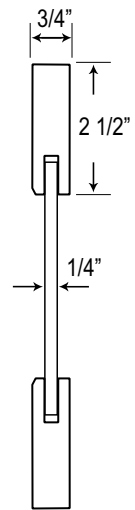

Flat Panel  
Mission Door

Name	Door Style	Door Options	Glass Options	Overlay Options	Hinge Options	Drawer Front	Drawer Glide Options
Middleton	Mission Cope & Stick 2 1/2"	Square	Clear Glass	1/2" Standard	European	Panel	Full Extension (F)
				1 1/4" Full	European Soft Close (SC)		Undermount Soft Close (S)

Available in these cabinet grades:



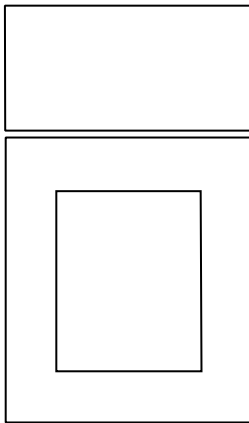

Solid Drawer Front  
Mission Flat Panel Door

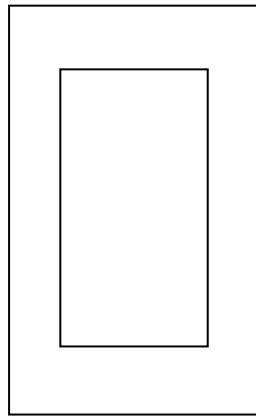

Mission  
Flat Panel Door

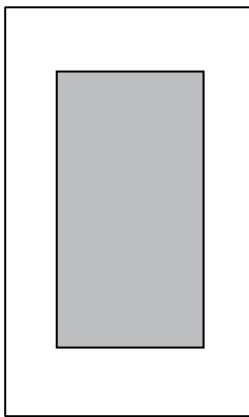

Mission  
Glass Door

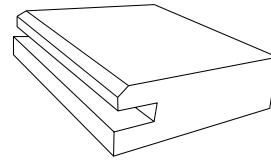

Inside Edge Profile

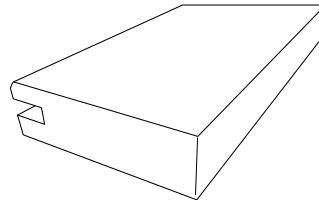

Outside Edge Profile

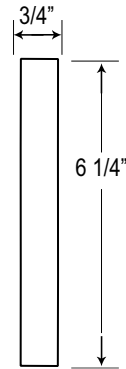

Mission  
Solid Drawer Front

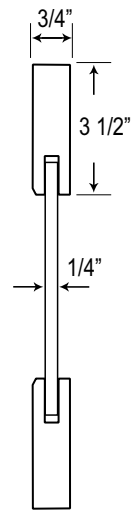

Flat Panel  
Mission Door

Name	Door Style	Door Options	Glass Options	Overlay Options	Hinge Options	Drawer Front	Drawer Glide Options
Berkshire	Mission Cope & Stick 3 1/2"	Square	Clear Glass	1/2" Standard	European	Solid	Full Extension (F)
				1 1/4" Full	European Soft Close (SC)		Undermount Soft Close (S)

Available in these cabinet grades:





# Flat Panel *(Pricing Level 2)*

# Door Style: Saybrook

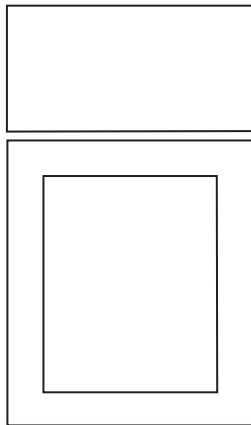

Solid Drawer Front  
Mission Reversed  
Raised Panel Door

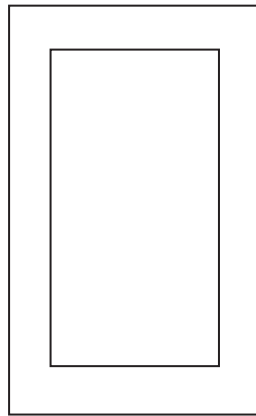

Mission Reversed  
Raised Panel Door

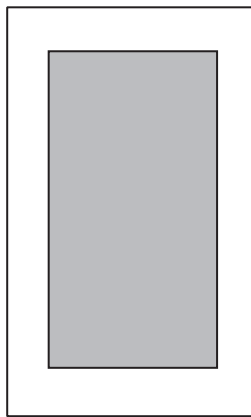

Mission Glass Door

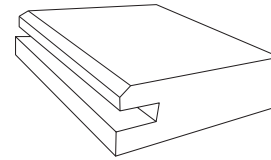

Inside Edge Profile

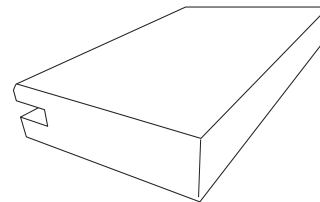

Outside Edge Profile

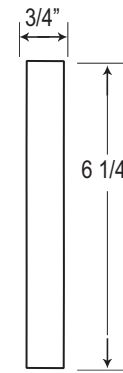

Flat Panel  
Mission  
Drawer Front

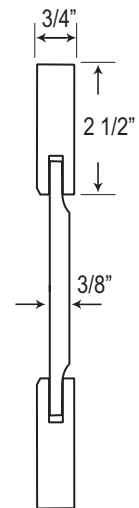

Mission Reversed  
Raised Panel  
Door

16  
B

Door Styles Flat Panel

Name	Door Style	Door Options	Glass Options	Overlay Options	Hinge Options	Drawer Front	Drawer Glide Options
Saybrook	Mission Cope & Stick	Square	Clear Glass	1/2" Standard	European	Solid	Full Extension (F)
				1 1/4" Full	European Soft Close (SC)		Undermount Soft Close (S)

Available in these cabinet grades:



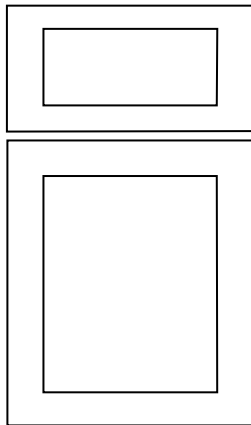

Panel Drawer Front  
Mission Reversed  
Raised Panel Door

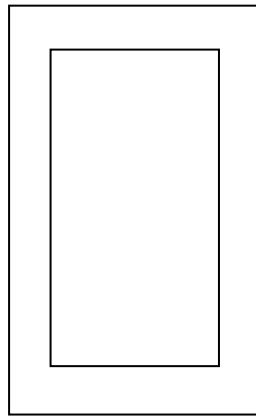

Mission Reversed  
Raised Panel Door

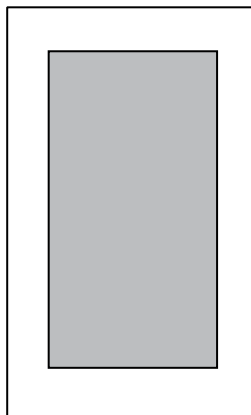

Mission Glass Door

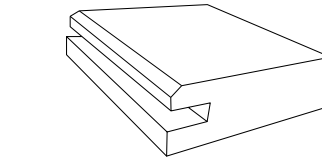

Inside Edge Profile

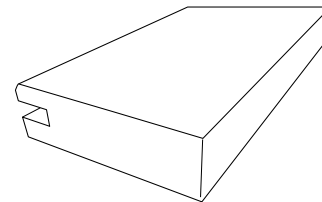

Outside Edge Profile

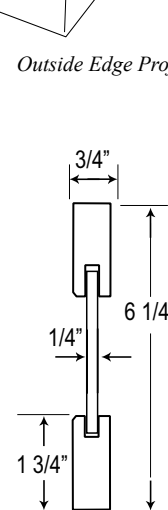

Flat Panel  
Mission  
Drawer Front

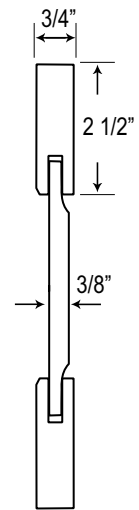

Mission Reversed  
Raised Panel  
Door

Name	Door Style	Door Options	Glass Options	Overlay Options	Hinge Options	Drawer Front	Drawer Glide Options
Stratton	Mission Cope & Stick 2 1/2"	Square	Clear Glass	1/2" Standard	European	Panel	Full Extension (F)
				1 1/4" Full	European Soft Close (SC)		Undermount Soft Close (S)

Available in these cabinet grades:



# Flat Panel

# Door Style: Newton (Pricing Level 3)

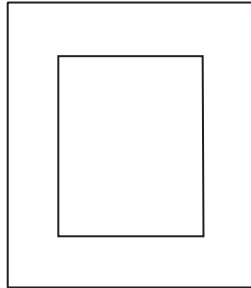
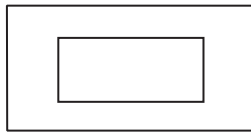

Panel Drawer Front  
Mission Flat Panel Door

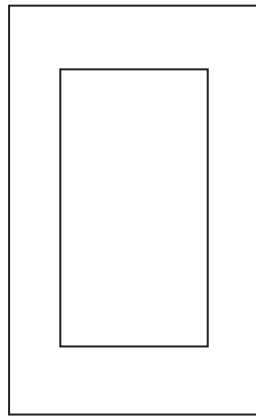

Mission  
Flat Panel Door

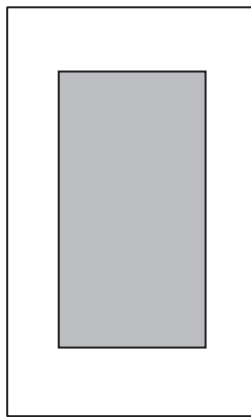

Mission  
Glass Door

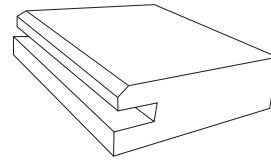

Inside Edge Profile

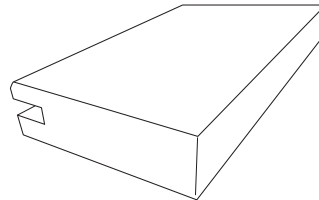

Outside Edge Profile

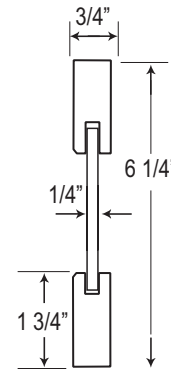

Mission  
Solid Drawer Front

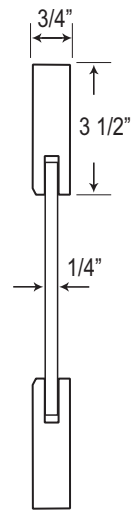

Flat Panel  
Mission Door

17  
B

Door Styles Flat Panel

Name	Door Style	Door Options	Glass Options	Overlay Options	Hinge Options	Drawer Front	Drawer Glide Options
Newton	Mission	Square	Clear Glass	1/2" Standard	European	Panel	Full Extension (F)
				1 1/4" Full	European Soft Close (SC)		Undermount Soft Close (S)

Available in these cabinet grades:



# Door Style: Windsor (Pricing Level 3)

# Reversed Raised Panel

18

Door Styles Raised Panel

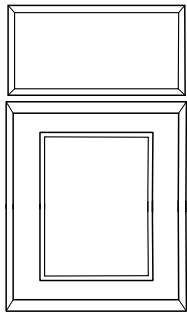

Solid Drawer Front Reverse Raised Panel Door

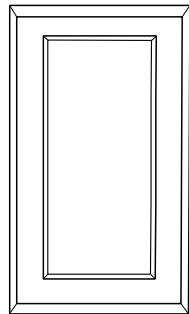

Reverse Raised Panel Door

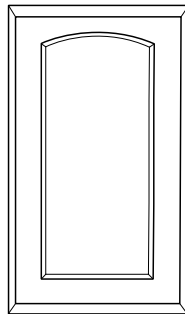

Arch Reverse Raised Panel Door

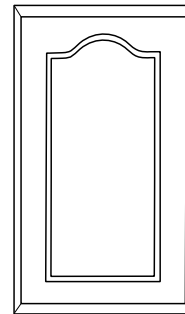

Cathedral Reverse Raised Panel Door

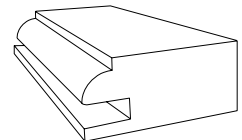

Inside Edge Profile

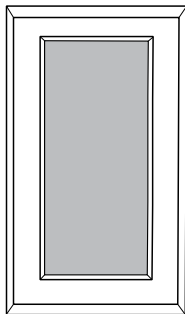

Square Glass Door

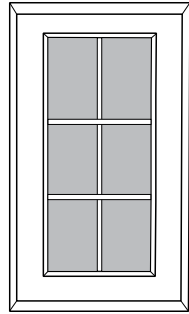

Square Mullion Glass Door

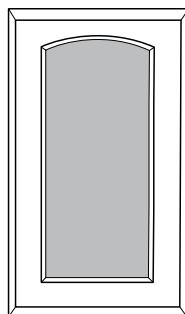

Arch Glass Door

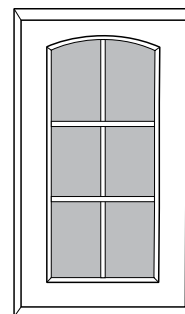

Arch Mullion Glass Door

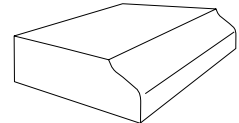

Outside Edge Profile

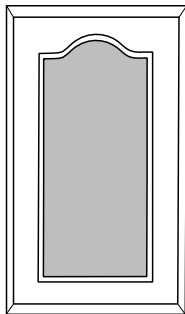

Cathedral Glass Door

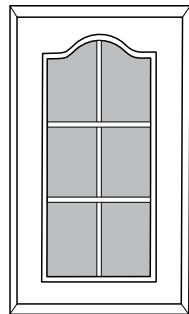

Cathedral Mullion Glass Door



Panel Profile

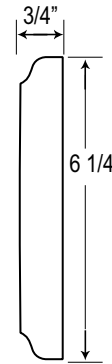

Solid Drawer Front

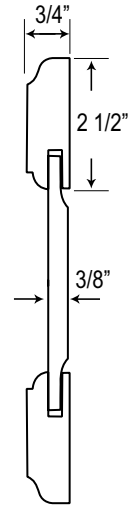

Reversed Raised Panel Door

**Note:** Arch top Rail is 3 1/2" high. Cathedral top Rail is 4 1/2" high.

Name	Door Style	Door Options	Glass Options	Overlay Options	Hinge Options	Drawer Front	Drawer Glide Options
Windsor	Reverse Raised Panel	Square	Clear Glass	1/2" Standard	European	Solid	Full Extension (F)
	Cope & Stick	Arch	Mullions	1 1/4" Full	European Soft Close		Undermount Soft Close (S)

Cathedral

Available in these cabinet grades:



# Raised Panel *(Pricing Level 2)*

# Door Style: Lynfield

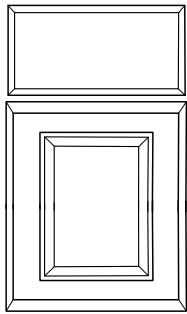

Solid Drawer Front  
Raised Panel Door

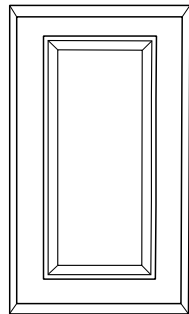

Raised Panel Door

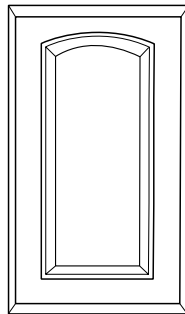

Arch  
Raised Panel Door

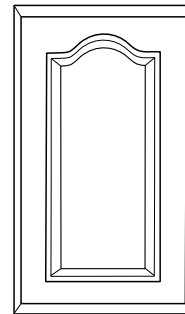

Cathedral  
Raised Panel Door

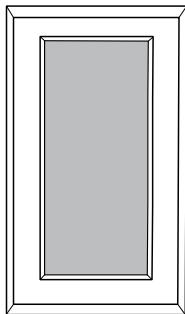

Square Glass Door

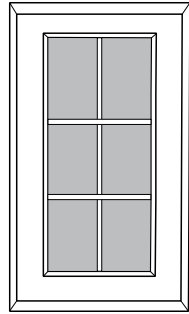

Square Mullion  
Glass Door

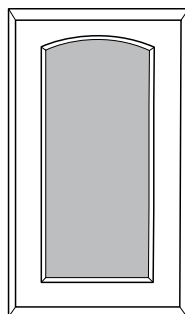

Arch  
Glass Door

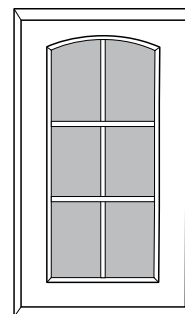

Arch Mullion  
Glass Door

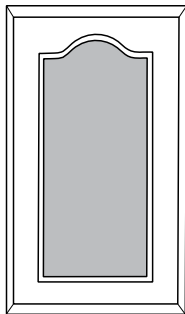

Cathedral  
Glass Door

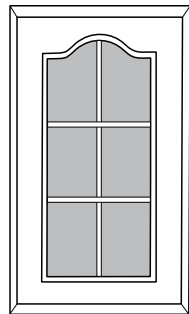

Cathedral Mullion  
Glass Door

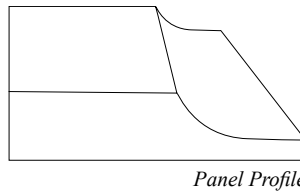

*Note: Arch top Rail is 3 1/2" high. Cathedral top Rail is 4 1/2" high.*

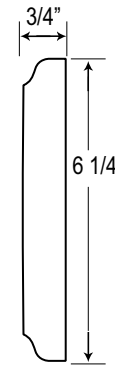

Solid  
Drawer Front

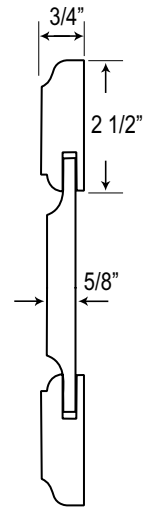

Raised  
Panel Door

Name	Door Style	Door Options	Glass Options	Overlay Options	Hinge Options	Drawer Front	Drawer Glide Options
Lynfield	Raised Panel	Square	Clear Glass	1/2" Standard	European	Solid	Full Extension (F)
	Cope & Stick	Arch	Mullions	1 1/4" Full	European Soft Close (SC)		Undermount Soft Close (S)
		Cathedral					

Available in these cabinet grades:



# Door Style: Bellingham (Pricing Level 5)

# Raised Panel



20

Door Styles Raised Panel

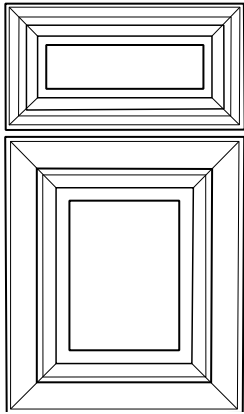

Mitered Raised Panel Drawer Front  
Mitered Raised Panel Door

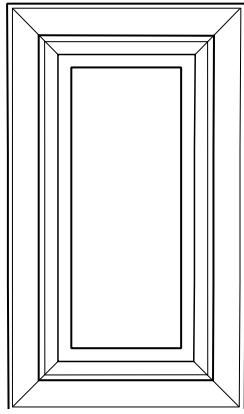

Mitered  
Raised Panel Door

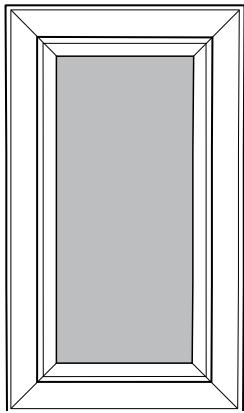

Mitered Glass Door

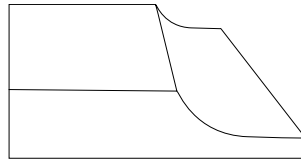

Panel Profile

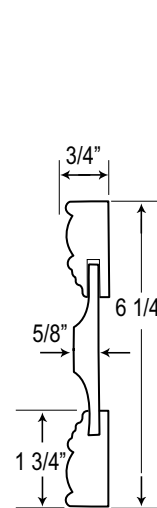

Raised Panel  
Mitered Drawer Front

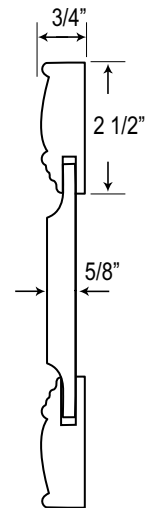

Raised Panel  
Mitered Door

Name	Door Style	Door Options	Glass Options	Overlay Options	Hinge Options	Drawer Front	Drawer Glide Options
Bellingham	Raised Panel Miter	Square	Clear Glass	1/2" Standard	European	Panel	Full Extension (F)
				1 1/4" Full	European Soft Close (SC)		Undermount Soft Close (S)

Available in these cabinet grades:



# Bead Board *(Pricing Level 2)*

# Door Style: Dartmouth

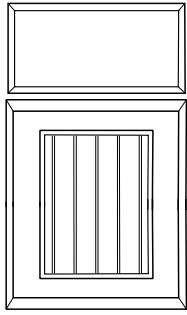

Solid Drawer Front  
Bead Board Door

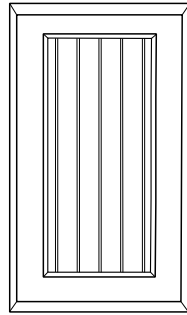

Bead Board Door

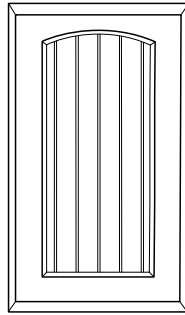

Arch  
Bead Board Door

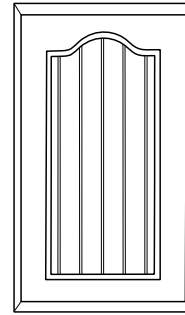

Cathedral  
Bead Board Door

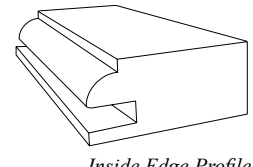

Inside Edge Profile

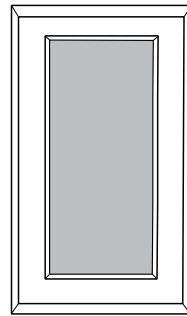

Square Glass Door

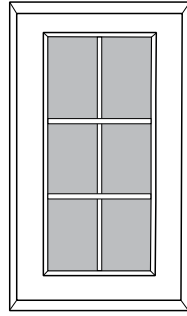

Square Mullion  
Glass Door

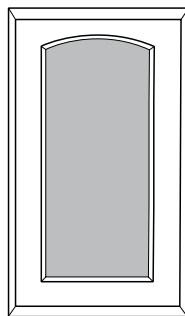

Arch  
Glass Door

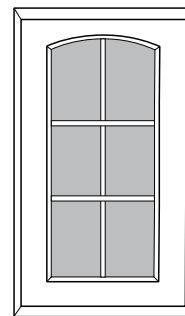

Arch Mullion  
Glass Door

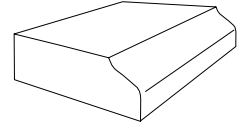

Outside Edge Profile

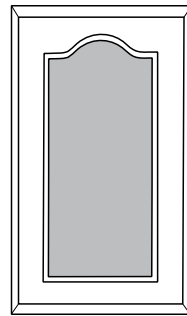

Cathedral  
Glass Door

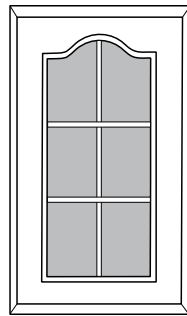

Cathedral Mullion  
Glass Door

*Note: Arch top Rail is 3 1/2" high.  
Cathedral top Rail is 4 1/2" high.*

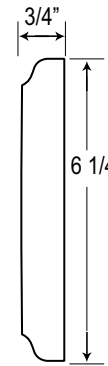

Solid  
Drawer Front

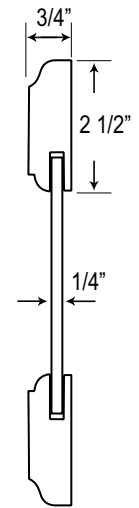

Flat Panel Door

Name	Door Style	Door Options	Glass Options	Overlay Options	Hinge Options	Drawer Front	Drawer Glide Options
Dartmouth	Beadboard	Square	Clear Glass	1/2" Standard	European	Solid	Full Extension (F)
	Square			1 1/4" Full	European Soft Close (SC)		
	Cope & Stick	Arch	Mullions			Undermount Soft Close (S)	
		Cathedral					

Available in these cabinet grades:



# Door Style: Albany

# Veneer Core Plywood *(Pricing Level 2)*



22

Door Styles Solid Slab

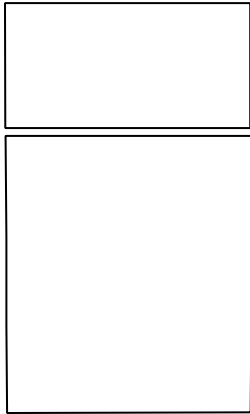

Plywood Drawer Front  
Plywood Door



Plywood Door

**NOTE:** Veneer Core Plywood is a stable material that minimizes potential quality issues related to solid wood plank doors.

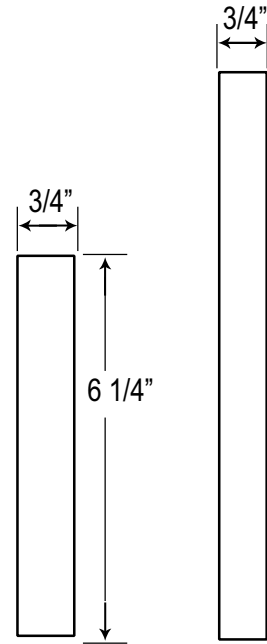

Solid Drawer Front      Solid Door

Name	Door Style	Door Options	Overlay Options	Hinge Options	Drawer Front	Drawer Glide Options
Albany	Plywood Door	Square	1/2" Standard	European	Veneer Core	Full Extension (F)
	Veneer Core		1 1/4" Full	European Soft Close (SC)	Plywood	Undermount Soft Close (S)

Available in these cabinet grades:





# Door Style Pricing Summary

Pricing Levels Based on Woodcraft Select  Cabinet Grade, Maple wood and stain finish.



23

Door Style Pricing Summary

Door Style/Name	Door/Drawer Front Description	Pricing Level
Winthrop	Flat Panel Cope and Stick Door / Solid Drawer front	1
Cameron	Flat Panel Mission Door / Solid Drawer Front	1
Middleton	Flat Panel Mission Door / Flat Panel Drawer Front	2
Berkshire	Flat Panel Mission 3 1/2" Rail & Stile Door / Solid Drawer Front	2
Lynfield	Raised Panel Door / Solid Drawer Front	2
Dartmouth	Beadboard Door / Solid Drawer Front	2
Albany	Solid Door / Solid Drawer Front	2
Claremont	Flat Panel Miter Door / Solid Drawer Front	3
Stratton	Reversed Raised Panel Door / Drawer Front	3
Windsor	Reversed Raised Panel Door / Solid Drawer Front	3
Lycoming	Flat Panel Miter Door / Flat Panel Miter Drawer Front	4
Rockport	Flat Panel Miter Door / Flat Panel Miter Drawer Front	4
Bellingham	Raised Panel Miter Door / Raised Panel Miter Drawer Front	5

**Option:** Pricing Variable

**Cabinet**

All Furniture Board Box 	-11%
Plywood Sides 	-5%
Full Overlay	No Change
Same Species Interior	Add 30%
Finished Side Wall Cabinet	\$80
Finished Side Base Cabinet	\$128
Finished Side Tall Cabinet	\$360

**Wood**

Maple Wood	No Change
Oak Wood	No Change
Cherry Wood	No Change

**Finish**

Unfinished	-28%
Stain with Glaze	Add 8%
Paint	Add 8%
Paint with Glaze	Add 15%
Rubbed Edges	Add 15%

**Option:** Pricing Variable

**Door**

Glass Doors/ Same Species Interior	+35%
Glass Mullion Door	\$42 per door
Arch Door	\$22 per door
Cathedral Door	\$22 per door

**Glide**

Full Ext. Ball Bearing Glides (F)	-\$70.00 per drawer
Soft Close Undermount Glides (S)	No Change
1/2" Drawer Box	-\$80.00 per drawer
5/8" Maple Drawer Box	No Change

# Cabinet Height Dimensions

## 84" Height Dimensions

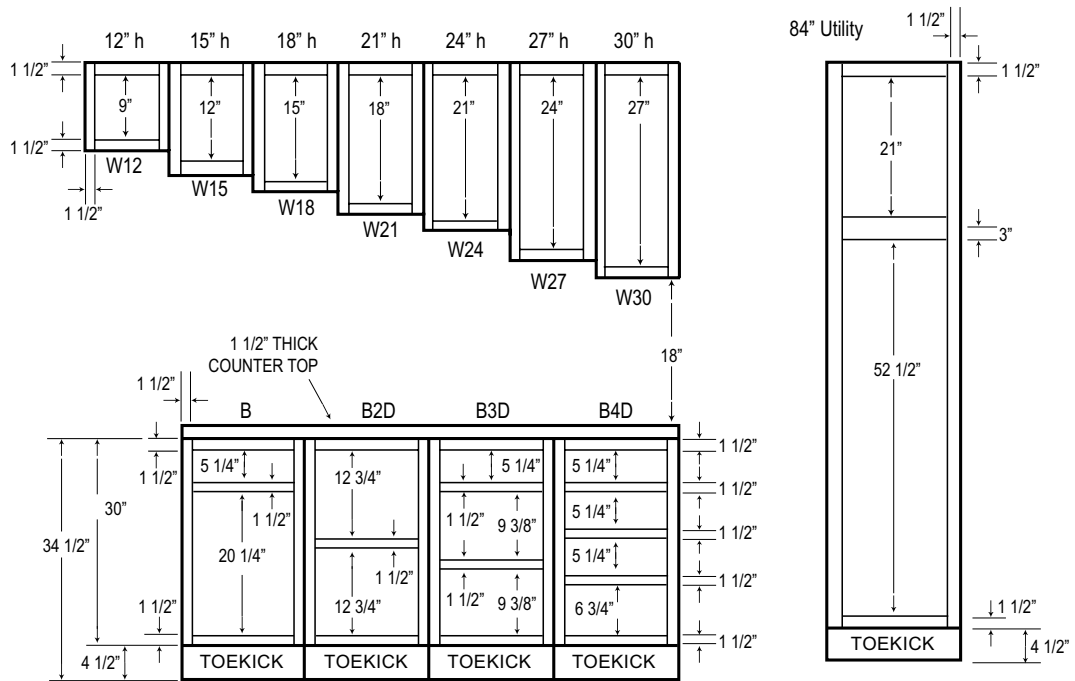

## 90" Height Dimensions

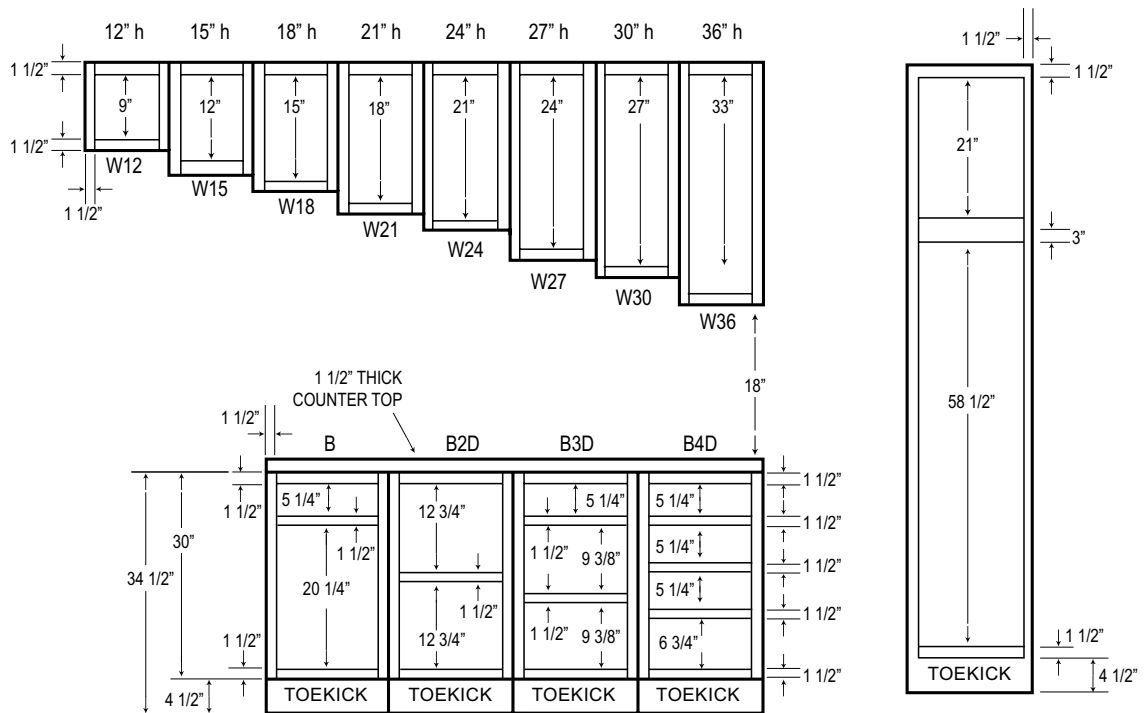

# Cabinet Height Dimensions

## 96" Height Dimensions

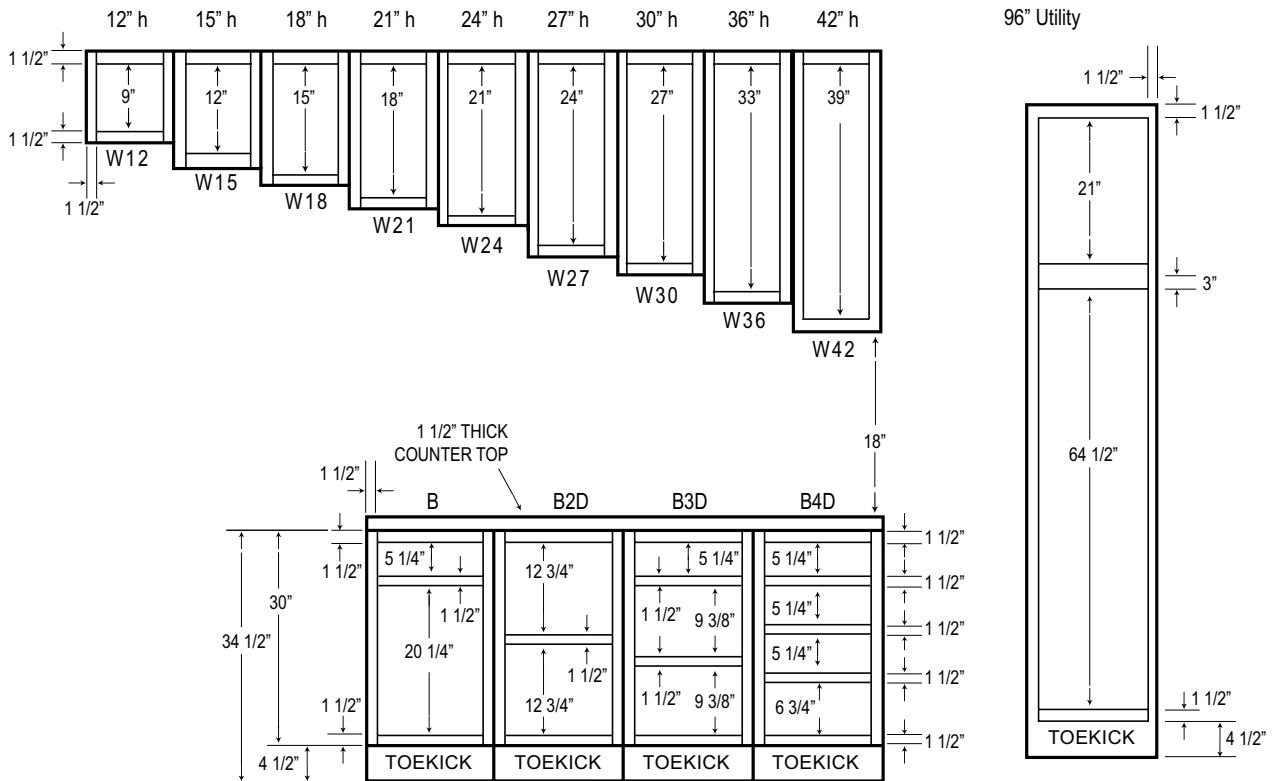

## Vanity Height Dimensions

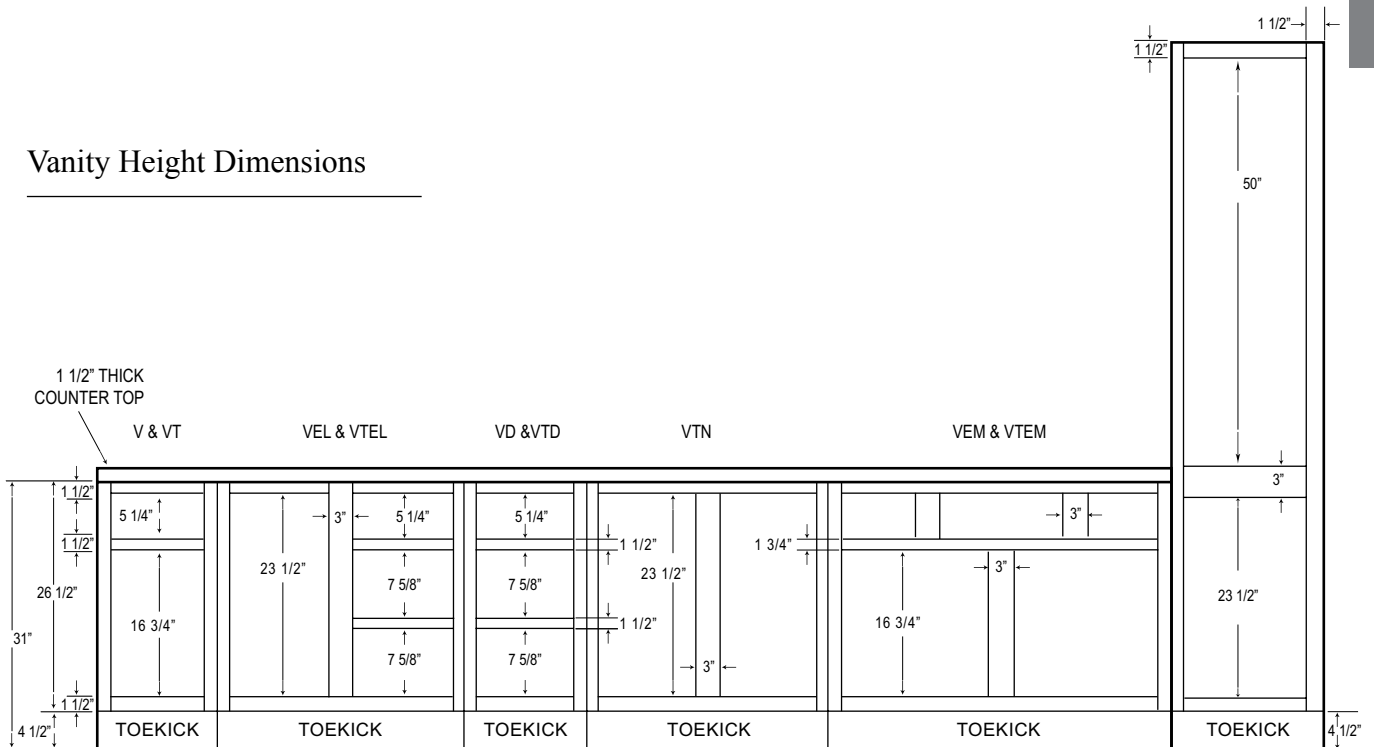

# Price Accessories Guide

26

Accessories



## Accessories

Silverware Divider		
24"W x 6"H x 12"D (.SD1)	\$92	
30"W x 6"H x 12"D (.SD2)	\$101	
Spice Racks and Shelves		
Rack 24"W x 6"H x 12"D (.SR1)	\$160	
Rack 30"W x 6"H x 12"D (.SR2)	\$165	
Shelf 15"W x 24 1/4"H x 3 1/8"D (.SS1)	\$177	
Shelf 18"W x 24 1/4"H x 3 1/8"D (.SS2)	\$204	
Shelf 21"W x 24 1/4"H x 3 1/8"D (.SS3)	\$211	
Tilt-Out Tray		
12"W (.T01)	\$149	
15"W (.T02)	\$157	
Towel Rack (.TR)	\$76	
Wire Basket (.WB)	\$99	
<b>Drawer Hardware</b> (per set)		
Full extension ball bearing glide		-\$70
Soft Close Undermount glides		No Change
1/2" Drawer Box		-\$80
5/8" Maple Drawer Box		No Change

Woodcraft Kitchen and Bath reserves the right to change prices at our discretion with or without notice.

NOTE: Prices shown are per cabinet, per drawer, or per door.

## Cabinets

All Furniture Board Box 	-11%
Plywood Sides with Furniture Board Box 	-5%
Full Overlay	No Change
Same Species Interior	Add 30%
Finished Side Wall Cabinet	\$80
Finished Side Base Cabinet	\$128
Finished Side Tall Cabinet	\$360

## Finish

Unfinished	-28%
Stain with Glaze	Add 8%
Paint	Add 8%
Paint with Glaze	Add 15%
Rubbed Edges	Add 15%

## Wood

Maple Wood	No Change
Oak Wood	No Change
Cherry Wood	No Change

## Door

Glass Doors with Finished Interior	Add 35%
Add Mullion to Glass Door	\$42.00 per door
Arch Door	\$22.00 per door
Cathedral Door	\$22.00 per door
Soft Close Door	\$20.00 per door

## Glide

Full Ext. Ball Bearing Glides	-\$70 per drawer
Soft Close Undermount Glides	No Change
1/2" Drawer Box	-\$80 per drawer
5/8" Maple Drawer Box	No Change

NOTE: Price % shown here are for reference only, the actual prices may vary. Woodcraft Kitchen and Bath reserves the right to change prices at our discretion with or without notice.

## CABINET DETAILS

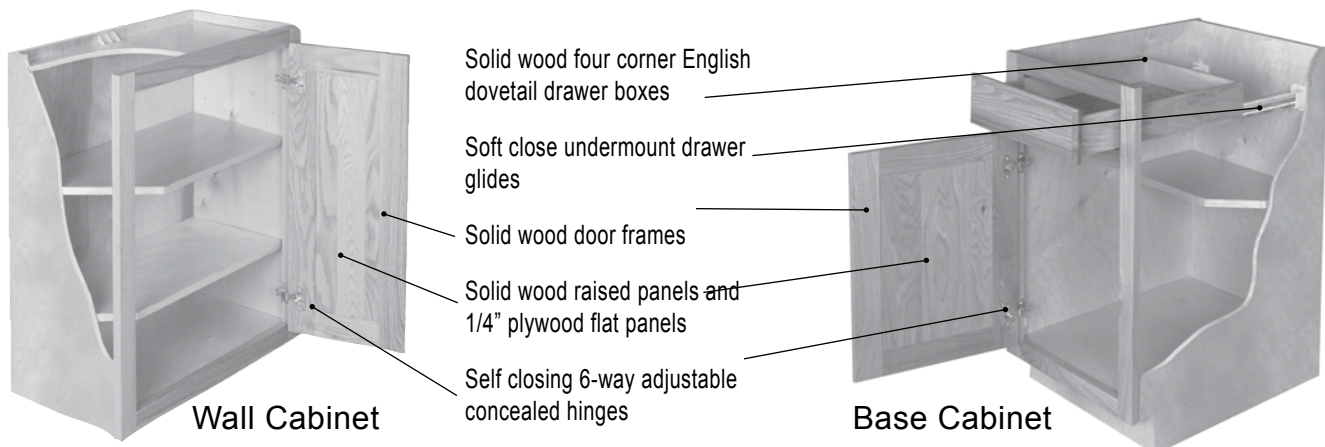

NOTE: Cabinet Prices on the following pages in this guide; apply your multiplier to suggest list price.

# Door Options Price Guide

## Options:

Arch Top Door Profile	Add \$22 per door panel to cabinet price.
Cathedral Top Door Profile	Add \$22 per door panel to cabinet price.
“Pull-out Tray (per installed pull-out tray) Available for 27”, 30”, 33”, and 36” Base Cabinets with No Center Style”	Add \$162 to cabinet price.  “Include .PO to end of model number for installed pull-out trays, specify number of pull-out trays desired.”
Doors or Drawer Fronts Loose	Add 15% to cabinet price.
Change 1/2 Shelf to Full Shelf	Add \$48 to cabinet price.
Glass Doors (per door)	\$42.00
Glass Doors add Mullions (per door)	\$42.00
Add .M to end of model number to add mullions to glass doors.	

**NOTE:** Price % shown here are for reference only, the actual prices may vary.  
Woodcraft Kitchen and Bath reserves the right to change prices at our discretion with or without notice.

## Box Modifications

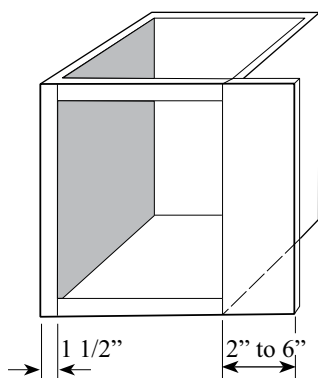

Extended Stile Option

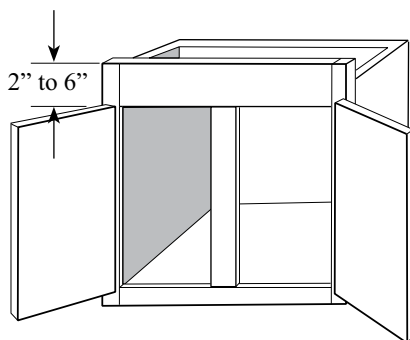

Extended Top Rail Option

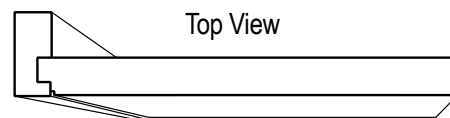

3/4" Thick Flush Side Option

Option	Add %
Extended Stile	10%
Extended Top Rail	10%
3/4" Thick Flush Sides	10%

# Modification Price Guide

## Modifications:

Increase cabinet height:	Add 25% to the cabinet price up to 6 inches. Add 50% to the cabinet price from 6 to 12 inches.
Increase cabinet width:	Add 25% to the cabinet price up to 6 inches. Add 50% to the cabinet price from 6 to 12 inches.
Increase cabinet depth:	Add 30% to the cabinet price, up to 6 inches. Add 50% to the cabinet price, 6 to 12 inches.

Decrease cabinet height:	Add 15% to cabinet price.
Decrease cabinet width:	Add 15% to cabinet price.
Decrease cabinet depth:	Add 15% to cabinet price.

## Finished sides on...

Wall Cabinets:	\$80.00
Base & Vanity Cabinets:	\$128.00
Utility, Pantry, & Oven Cabinets:	\$360.00

Remove center stile:	Add 10% to cabinet price.
Base cabinets-full doors, no drawers:	Deduct 5% from cabinet price
Base cabinets-no doors, no drawers fronts:	Deduct 5% from cabinet price
Wall cabinets-no doors:	Deduct 5% from cabinet price

**NOTE:** Price % shown here are for reference only, the actual prices may vary.  
Woodcraft Kitchen and Bath reserves the right to change prices at our discretion with or without notice.



## Wall Cabinets

- Standard wall cabinets come in 12", 15", 18", 21", 24", 27", 30", 36" and 42" heights with a 12" or 15" depth.
- 12" 15" and 18" high wall cabinets have no interior shelves
- 21", 24", and 27" high wall cabinets have one adjustable shelf.
- 30" and 36" high cabinets have two adjustable shelves.
- 42" high cabinets have three adjustable shelves.
- Max. height for wall cabinets: 48"
- Smallest door size for Cathedral/ Arch doors is 9" w X 12" h
- Cabinets less than 12" wide have a solid door (raised, flat panel, cathedral and arch not available).

## Vanity Cabinets

- Standard vanities are 31" high and 21" deep, have false drawer fronts, bottom shelf. Tall vanities are 34 1/2" high.
- Narrow vanities are 31" or 34 1/2" high and 18" deep, have false drawer fronts, one bottom shelf.
- Three drawer vanities are 31" or 34 1/2" high and 21" deep, have one 4" and two 6" drawers. (Hampshire is 21 3/4" deep because of base trim).
- Combination vanities are 31" or 34 1/2" high and 21" deep.
- Toe kick cutout: 4 1/2" high and 3" deep.

## Base Cabinets

- Standard base cabinets are 34 1/2" high and 24" deep, have working drawers, one base shelf and one adjustable half-shelf.
- Sink bases have one base shelf and false drawer fronts.
- Sink fronts are fronts only, with a toe kick attached.
- Three-drawer base cabinets have one 4" and two 8" high drawers.
- Min. cabinet depth for drawers: 12"
- Cabinets less than 12" wide have a solid door (raised, flat panel, cathedral and arch not available).
- Toe kick cutout: 4 1/2" high and 3" deep.

## Helpful Ordering Information

### Ordering Wall Cabinets

The first letters of cabinet model numbers refer to the group of cabinet-type ("W" for wall).

• The numbers after the letters refer to the width of the cabinet. In the example below, the "24" indicates that the actual width of the cabinet is 24".

• The second set of numbers refers to the cabinet height. In the example, the "36" indicates that the actual height of the cabinet is 36 inches.

• If the cabinet has a non-standard depth (*standard depth is 12"*), the next two digits reflect the depth. In the example, the "15" indicates that the actual depth of the cabinet is 15 inches. If a cabinet is the standard 12" depth, this number is not required.

- The letter following the height or the depth option is used for the wood species. "M" is the letter code for Maple, "K" is the letter code for Oak, "C" is the letter code for Cherry.

#### Wall Cabinet Order Number

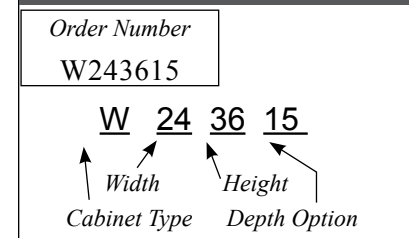

### Ordering Base & Vanity Cabinets

Letters at the beginning of cabinet model numbers, such as "B", refer to the group of cabinet-type

("B" for Base, "V" for vanity, "BLS" Base Lazy Susan, etc.)

• The numbers after the letters refer to the width of the cabinet.

• In the order number example below, the "27" indicates that the actual width of the cabinet is 27".

• The letter following the width is used for the wood species.

- "M" is the letter code for Maple, "K" is the letter code for Oak, "C" is the letter code for Cherry.

#### Base & Vanity Order Number

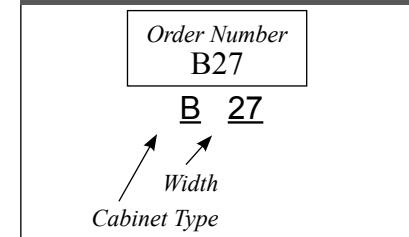

### Ordering Blind Cabinets

• For Blind Wall cabinets order 0"- 3" smaller than wall space as it can be pulled 0"-3" from the wall

• For Blind Base cabinets order 6"- 9" smaller than wall space as it can be pulled 6"-9" from the wall.

	Wall Space	
	Min"	Max"
WBL24	24"	27"
WBL30	30"	33"
WBL36	36"	39"
WBL42	42"	45"
WBL48	48"	51"

Blind Wall Cabinets

	Wall Space	
	Min"	Max"
BL27	33"	36"
BL30	36"	39"
BL33	39"	42"
BL36	42"	45"
BL42	48"	51"
BL48	54"	57"

Blind Base Cabinets